

# QUICK REFERENCE GUIDE

## SETUP AND USE

- 1.** Fully immerse the filter in cold tap water and soak for 15 minutes (See complete instructions on page 7 of your Instruction Booklet). Insert the charcoal water filter into the water filter holder. Open the water reservoir and insert into the unit.

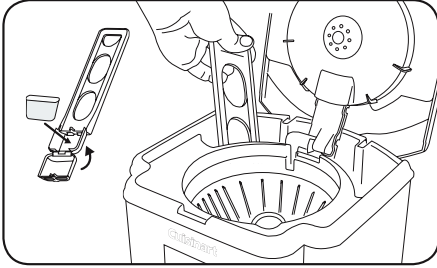

- 2.** Pour your desired amount of water using the stair step cup measure inside the water reservoir.

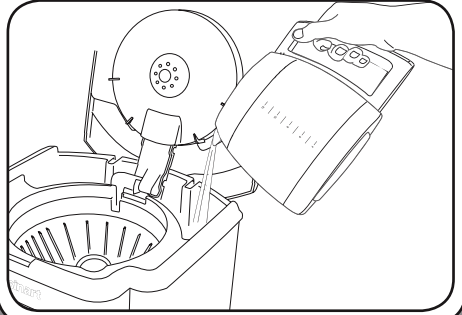

- 3.** Insert a permanent gold tone filter or paper filter into the filter basket holder. Using the scoop provided, add 1 scoop of ground coffee per cup. Adjust the amount to taste and close the lid.

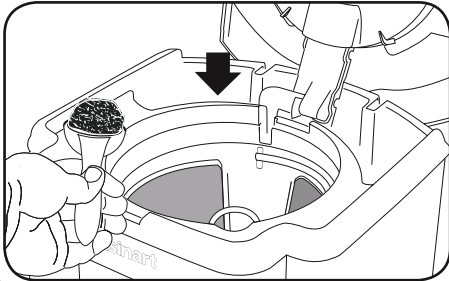

- 4.** Make sure the filter basket is securely in place and lid is completely closed.

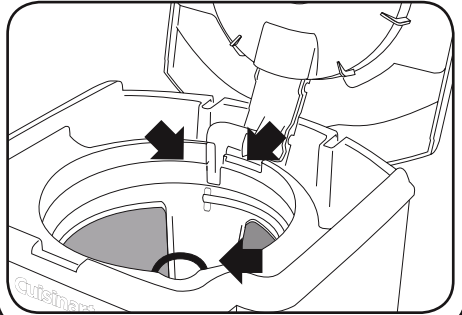

- 5.** To brew coffee, turn the Function Knob to the Brew position. Then flip the switch to the ON position and release. The red ON indicator light will illuminate and brewing will begin.

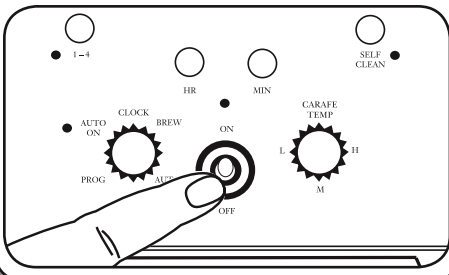

## IMPORTANT!

**Do not throw away. Read before operating your new coffeemaker. Keep for further reference.**

These helpful hints are intended to be a supplement to the instruction booklet. In order to ensure proper operation and optimum performance, please read the entire Instruction Booklet.

**Please see reverse side for programming instructions.**

# QUICK REFERENCE GUIDE

## PROGRAMMING

- 1. To set the Time:** Turn the Function Knob to Clock. Press and hold the Hour or Minute button until the clock begins flashing. Hold down the Hour or Minute button to scroll through the numbers. When desired time approaches, release the button and press repeatedly to advance one digit at a time. To finish, wait for the numbers to stop flashing.

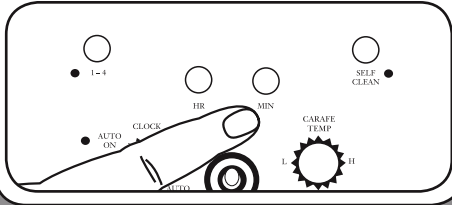

- 2. To program the Auto-On:** Turn the Function Knob to PROG, the AUTO ON LED will flash. Set the time you want coffee to begin brewing (follow "set the time" instructions). Once complete, turn the Function knob to AUTO ON and flip the switch to the ON position and release. The green indicator light will come on to remind you that the programming function is in use.

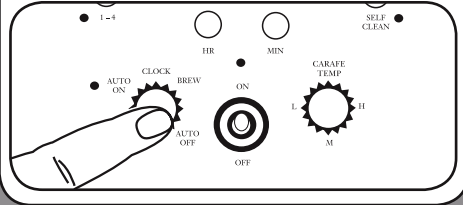

- 3.** At the programmed time, the red On/Off indicator light will come on, indicating that the brew cycle is starting.

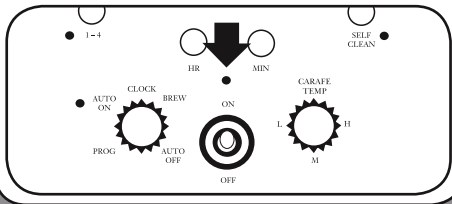

- 4.** To start the brew cycle at the same time the next day, simply turn the knob to PROG. The green Auto-On will illuminate.

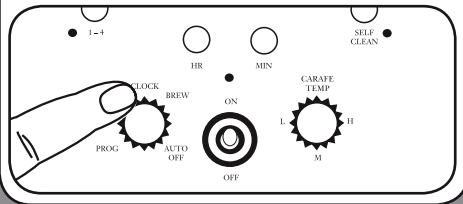

- 5. To program the Auto Off:** Turn the Function Knob to Auto Off. Use the Hour and Minute buttons as in #1 (to set the time) to program your coffeemaker to shut off from 0 to 4 hours after brew cycle is finished.

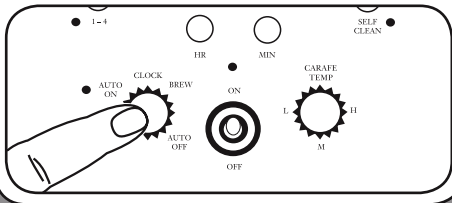

# Cuisinart®

## Brew Central™

### 12-Cup Coffeemaker

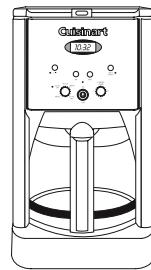

Please see reverse side for setup and use instructions.